

7 Crossland Road, Chorlton Green, Manchester, M21 9DU



**JP&Brimelow**  
ESTATE AGENTS



# Offers In The Region Of £335,000

🛏 2 🚿 1 🛏 1 ≡ c

\*\*\*VIDEO TOUR AVAILABLE\*\*\* A charming and well presented, TWO DOUBLE BEDROOM, mid terrace garde Situated in the heart of Chorlton Green on sought-after Crossland Road. Within walking distance to good local primary schools, close to Beech Road with its cafe society and nearby to the Chorlton meadows and the Ees for walks, runs and cycling along the River Mersey. This characterful period property consists of a through lounge/ dining area, the lounge benefitting from an exposed brick fireplace and log burning stove. A modern fitted kitchen to the rear which allows access into the rear outside space. To the first floor there are two good sized double bedrooms and a white three-piece bathroom suite. The property benefits from gas central heating, double glazing, private courtyard and a large rear communal garden fronted property.







## EPC Chart

Energy Efficiency Rating		Current	Potential
Very energy efficient - lower running costs			
(92 plus) <b>A</b>			<b>90</b>
(81-91) <b>B</b>			
(69-80) <b>C</b>		<b>71</b>	
(55-68) <b>D</b>			
(39-54) <b>E</b>			
(21-38) <b>F</b>			
(1-20) <b>G</b>			
Not energy efficient - higher running costs			
<b>England &amp; Wales</b>		EU Directive 2002/91/EC	



Tenure: **Freehold** Council Tax Band: **B**



## Ground Floor



## First Floor

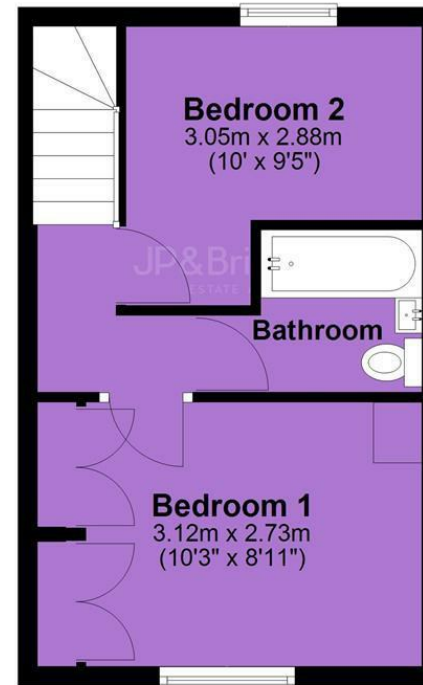

JP & Brimelow Estate Agents Ltd  
 430 Barlow Moor Road, Manchester, M21 8AD  
 Tel: 0161 8822233  
 E: sales@jpbrimelow.co.uk www.jpandbrimelow.co.uk



**JP & Brimelow**  
 ESTATE AGENTS

NOTICE: JP & Brimelow Estate Agents Ltd for themselves and for the vendors or lessors of this property whose agents they are give notice that:

- (i) the particulars are set out as a general outline only for the guidance of intending purchasers or lessees, and do not constitute, nor constitute part of, an offer or contract;
- (ii) all descriptions, dimensions, references to the condition and necessary permissions for use and occupation, and other details are given in good faith and are believed to be correct but any intending purchasers or tenants should not rely on them as statements or representations of fact but must satisfy themselves by inspection or otherwise as to the correctness of each of them;
- (iii) no person in the employment of JP & Brimelow Estate Agents Ltd has any authority to make or give any representation or warranty whatever in relation to this property.

jpandbrimelowestateagents

@jpandbrimelow